

SR.NO.	NO OF RING	RING SIZE FROM BOTTOM (APPROX)	WINDOW SIZE FROM BOTTOM	WINDOW RADIUS AT TOP / BOTTOM OF WINDOW	
1.	5 NOS	390X145	1. $\frac{270}{280} \times 490$	$\frac{R2}{R1}$	$\frac{135}{140}$
2.	3 NOS	355X145	2. $\frac{250}{270} \times 470$	$\frac{R4}{R3}$	$\frac{125}{135}$
3.	3 NOS	315X145	3. 155MMDIA.	---	---
4.	5 NOS	290X145	4. $\frac{220}{230} \times 760$	$\frac{R6}{R5}$	$\frac{110}{115}$
5.	3 NOS	270X145	5. $\frac{190}{210} \times 760$	$\frac{R8}{R7}$	$\frac{95}{105}$
6.	3 NOS	250X145	6. $\frac{160}{180} \times 760$	$\frac{R10}{R9}$	$\frac{80}{90}$
7.	3 NOS	200X145	7. $\frac{135}{155} \times 760$	$\frac{R12}{R11}$	$\frac{67.5}{77.5}$
8.	3 NOS	170X145	8. $\frac{110}{130} \times 760$	$\frac{R14}{R13}$	$\frac{55}{65}$
9.	6 NOS	140X145	9. $\frac{85}{105} \times 760$	$\frac{R16}{R15}$	$\frac{42.5}{52.5}$
10.	11 NOS	110X145	10. $\frac{65}{85} \times 760$	$\frac{R18}{R17}$	$\frac{32.5}{42.5}$
45 NOS -					

NOTE:-

1. THE DIMENSIONS SHOWN ARE IN MM.
2. ALL STIRRUPS SHALL BE WELDED AT LAPS.
3. APPROXIMATE WEIGHT OF POLE 650 KG.
4. BOTTOM & TOP OF PSC POLE SHALL BE PAINTED WITH ANTICORROSIVE BLACK EPOXY BASE BITUMINOUS PAINTS.
5. 4 MM Ø H.T. STEEL STIRRUPS 45 NOS.
6. TENSION WIRE -4MM H.T. STEEL -18NOS.
7. CONCRETE GRADE -M-45.
8. WORKING LOAD 270 KG.
9. FACTOR OF SAFETY - 2.5
10. WEB THICKNESS 63MM.

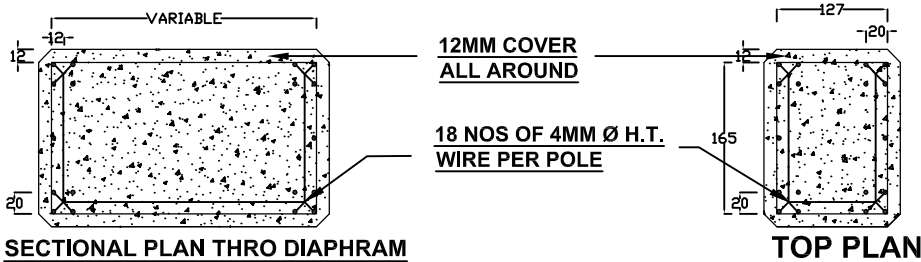

Remarks: All the windows to be make Round & Detail drawing shall be provided to Successful bidder with order / LOI.

UTTAR GUJARAT VIJ COMPANY LTD.

Prestressed Concrete Pole 10 Mtr/270Kg.s showing detailed dimensions for readymade PSC Pole.

Regenerated from GEB Drg. no. PKM/PSC/POLE/01/

<u>DRAWN:</u>	<u>CHECKED:</u>	<u>APPD:</u>	 SIZE: A4
<u>SCALE:</u>	<u>DATE:</u>	<u>DRG. NO:</u>	
N. T. S.	18/06/2011	UGVCL/CIVIL/10MTR PSC Pole/1	SHEET: 2 OF 2 REV: R0