

NOTES :-

- (1) MADE OUT OF (THERMOSETTING PLASTIC) SHEET MOULDING COMPOUND BY THE PROCESS OF HOT PRESS COMPRESSION MOULDING CONFIRMING TO IS : 13410
- (2) SMC BASE OR DOOR SHALL NOT SOFTEN OR BEND ON HEATING.
- (3) DOOR FITTED TO BASE BY CONCEALED HINGES.
- (4) TRANSPARENT COVER ON VIEWING WINDOW IS FITTED BY S.S. FRAME.
- (5) DIMENSION :- (MINIMUM)  
INSIDE :- H=375mm, W=270mm, D=210mm
- (6) COLOUR :- OFF WHITE

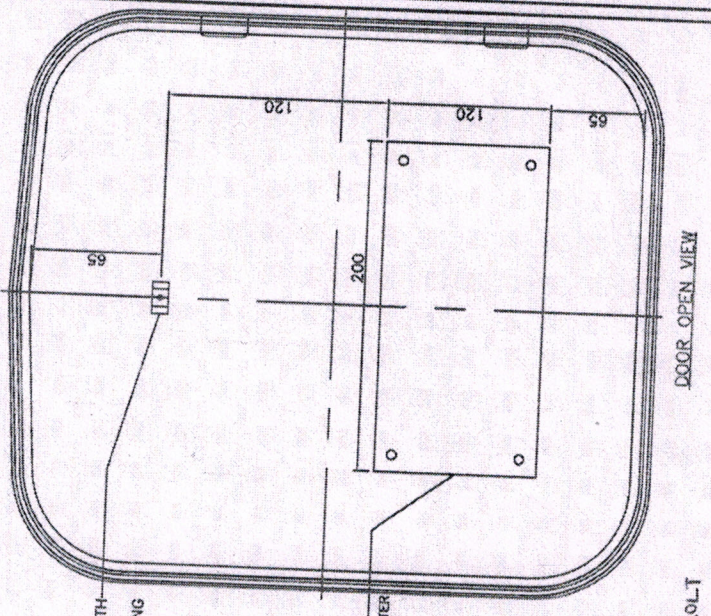
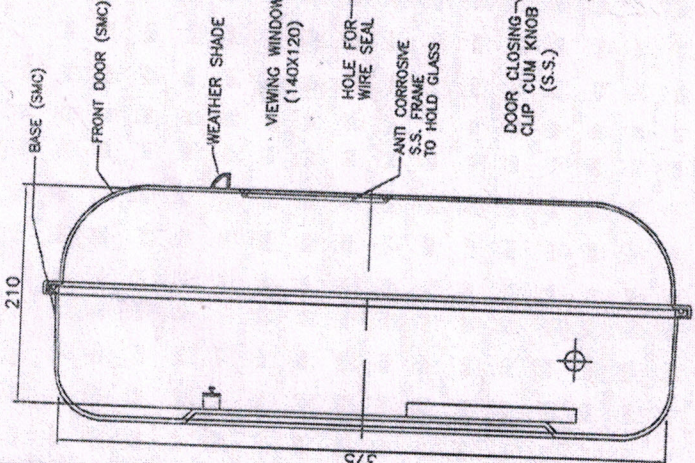
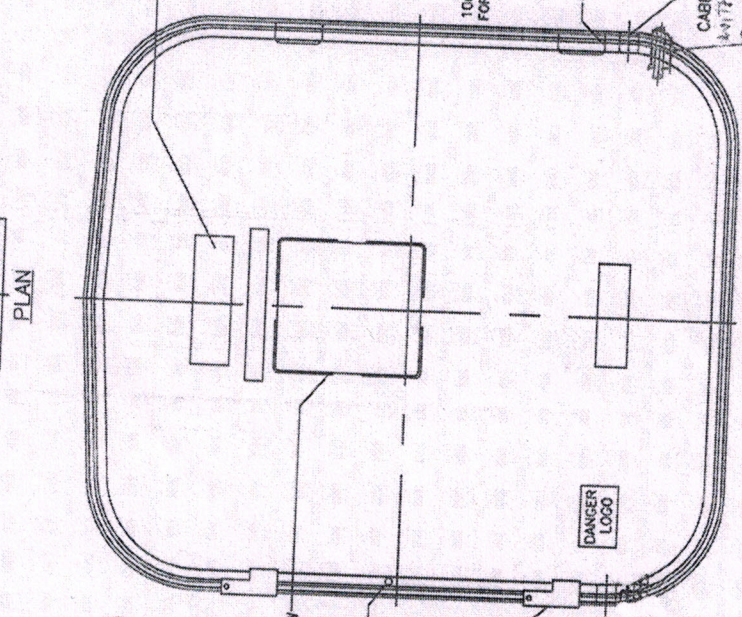
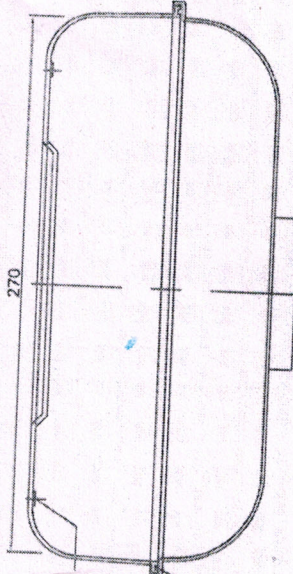

REV-1